



# SAMSUNG SMART SIGNAGE

## QBH-TR / QBN-W

Revitalize Productive Collaboration through Refined Interactive E-board Technology

Samsung's QBH-TR / QBN-W e-boards elevate information sharing and drive more productive conversation in classroom and meeting room settings through an interactive, all-in-one format. These versatile displays eliminate common meeting obstacles and allow groups to explore new ideas quickly and easily.

### HIGHLIGHTS

- Deliver a smooth, comfortable digital writing experience
- Enable up to four participants to write simultaneously with any tool
- Streamline efficient meeting facilitation via the embedded MagicIWB S5 solution
- Alternate between content sources with an intuitive UX
- Improve real-time interaction and introduce new ideas through advanced connectivity
- Elevate content quality with crisp UHD resolution
- Enhance meeting room sophistication through a stylish, pristine design

## INDUSTRY TRENDS

Today's meeting rooms and classrooms require interactive capabilities that exceed those offered by projectors and whiteboards. Not surprisingly, more are turning to advanced displays that promote simultaneous collaboration. E-boards' popularity, and revenue, only is expected to grow further in the near future.

## WHY SAMSUNG QBH-TR / QBN-W SERIES?

Samsung's QBH-TR / QBN-W e-boards offer a versatile, all-in-one arena for improved collaboration. Enhanced touch technology, the intuitive MagicIWB S5 solution and UHD picture quality come together to boost productivity and collaboration by facilitating engaging, efficient interaction.

## KEY FEATURES



### ENHANCE TOUCH, ENHANCE CAPACITY

Leverage heightened touch functionality for a smooth and versatile digital writing experience. Up to four users can write simultaneously using the provided pen or virtually any other tool.

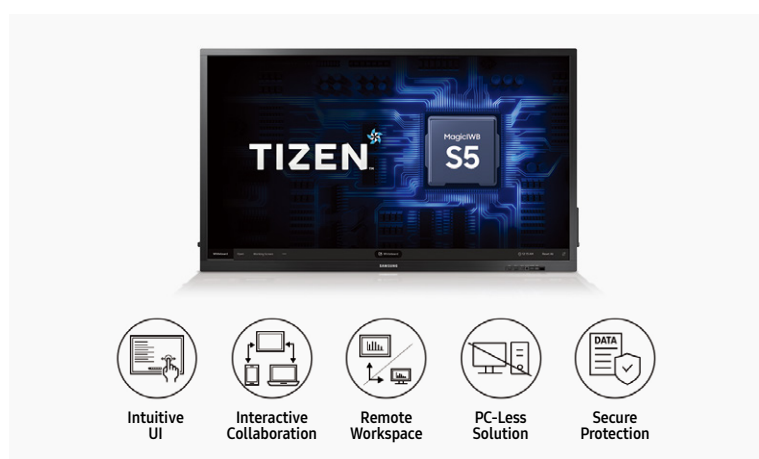

### ELEVATE COLLABORATION QUALITY, ALL-IN-ONE

The embedded MagicIWB S5 solution facilitates discussion management and organization with an intuitive interface for quick access to vital collaborative functionalities such as screen mirroring and real-time notation saving.



### SWITCH SOURCES SEAMLESSLY

Through the Working Screen function, users can quickly switch between multiple screens, such as the whiteboard, internet browser and connected input sources, with just a few touches.



## RETRIEVE AND CONTROL CONTENT REMOTELY

Pull and edit content on remote laptops directly through the central screen utilizing touch functionality. The powerful Knox system secures the Remote Workspace connection to protect against information leakage and meddling.

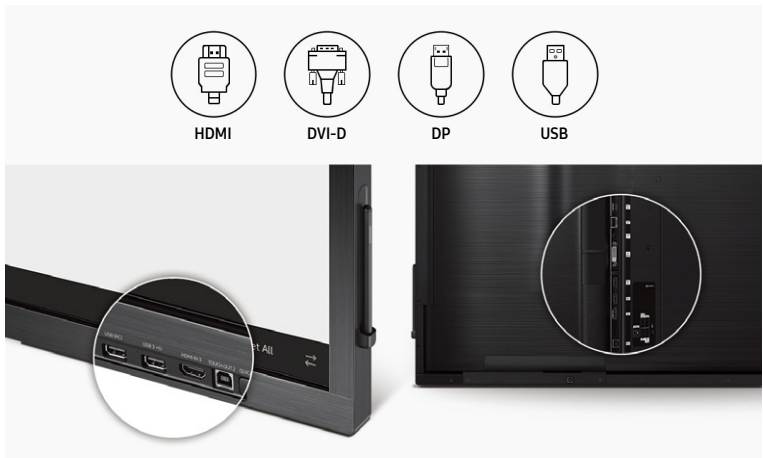

## CONNECT WITH CONVENIENCE

Each e-board offers a wide range of connections including HDMI, DVI-D, DP and USB ports, where users can load, share and revise content directly from their personal devices.



## AMPLIFY VISUAL PRESENTATION

Bring collaborative ideas to life through advanced UHD picture quality. Through ultra-high resolution, ensure all notations and introduced content are clear and legible for every participant.



## MAINTAIN ORGANIZATION WITH STYLE

Drive more organized collaboration with a sleek, sophisticated design. The magnetic side pen holder and frontal connection ports keep needed functions within reach, without the mess.



# SPECIFICATIONS

MODEL			QB65H-TR	QB75N-W
Panel	Diagonal Size		65	75
	Type		60Hz E-LED	120Hz Direct LED
	Resolution		3,840 x 2,160	3,840 x 2,160
	Brightness(Typ.)		300nit (w/o Touch Glass)	300nit (w/o Touch Glass)
	Contrast Ratio(Typ.)		Mega	Mega
	Viewing Angle(H/V)		178:178	178:178
	Response Time(G-to-G)		8ms	8ms
Operation Hour			16/7	16/7
Sound	Speaker Type		Built in Speaker (10W x 2) (Down Firing w/Bass Reflex)	Built in Speaker (10W x 2) (Down Firing w/Bass Reflex)
Connectivity	INPUT	RGB	N/A	N/A
		VIDEO	HDMI Rear1, HDMI Rear2 (ver 2.0), HDMI Front3 (ver 1.4), DVI-D, DP	HDMI Rear1, HDMI Rear2 (ver 2.0), HDMI Front3 (ver 1.4), DVI-D, DP
		AUDIO	N/A	N/A
		USB	USB 1, 2 (Rear), USB 3 (Front), PC USB (Front)	USB 1, 2 (Rear), USB 3 (Front), PC USB (Front)
	OUTPUT	RGB	N/A	N/A
		VIDEO	N/A	N/A
		AUDIO	Audio	Audio
		Touch Out	Touch Out 1 (Rear), Touch Out 2 (Front)	Touch Out 1 (Rear), Touch Out 2 (Front)
	INTERNAL	SENSOR	N/A	N/A
	EXTERNAL	CONTROL	RS232C(in/out) thru stereo jack, RJ45, Wi-Fi	RS232C(in/out) thru stereo jack, RJ45, Wi-Fi
Touch	Type		IR (Infra Red)	IR (Infra Red)
	# of Drawing		4 drawing (SoC), 10 drawing (External Windows PC)	4 drawing (SoC), 10 drawing (External Windows PC)
	Touch Pen Type		Passive Pen	Passive Pen
	Object Recognition Range		8mm	8mm
	Touch Response Time		7ms (Single Touch)	7ms (Single Touch)
Power	Type		Internal	Internal
	Power Supply		AC 100~240V 50/60Hz	AC 100~240V 50/60Hz
	Power Consumption	Rating[W/h]	150 (Max 165)	200 (Max 220)
		Typical[W/h]	115	157
Mechanical Spec	Dimension (mm)	Set	1514.7 x 882.4 x 58.2	1741.5 x 1012.1 x 81.2
		Package	1619 x 231 x 1001	1905 x 1175 x 307
	Weight (kg)	Set	39.2	57.4
		Package	48.0	69.5
	Color		Black	Black
	VESA Mount		400 x 400	400 x 400
	Protection Glass		Yes	Yes
	Stand Type		Wall Mount	Wall Mount
	Media Player Option Type		N/A	N/A
	Rotation		N/A	N/A
	Power Cable Length		1.8m	3m
	Accessory		Pen Holder	Pen Holder
Operation	Operating Temperature		0°C~ 40°C	0°C~ 40°C
	Humidity		10~80%	10~80%
Feature	Key		Slim & Light LFD with Built-in MagicInfo Player S5, SSSP	Slim & Light LFD with Built-in MagicInfo Player S5, SSSP
	Special	H/W	Super Clear Coating, Temperature Sensor, Pivot Display, Clock Battery (168hrs Clock Keeping), Built in Speaker(10W x 2), WiFi Module Embedded	Super Clear Coating, Temperature Sensor, Pivot Display, Clock Battery (168hrs Clock Keeping), Built in Speaker(10W x 2), WiFi Module Embedded
		S/W	MagicIWB S5	MagicIWB S5
		Platform	Kant-M (Tizen 3.0)	Kant-M (Tizen 3.0)
		Processor	Coretex A72 1.7GHz Quad-Core CPU	Coretex A72 1.7GHz Quad-Core CPU
		On-Chip Cache Memory	L1 Instruction Cache : 48KB / L1 Data Cache : 32KB / L2 Cache : 2MB	L1 Instruction Cache : 48KB / L1 Data Cache : 32KB / L2 Cache : 2MB
		Clock Speed	1.7GHz Quad-Core CPU	1.7GHz Quad-Core CPU
		Main Memory Interface	3GB 3ch 64bit LPDDR4 1.6GHz	3GB 3ch 64bit LPDDR4 1.6GHz
	Internal Player (Embedded H/W)	Graphics	2D & 3D Graphic Accelerator Data Format : 32bpp Output resolution : 3840x2160p	2D & 3D Graphic Accelerator Data Format : 32bpp Output resolution : 3840x2160p
		Storage	8GB (3.88GB Occupied by O/S, 4.12GB Available)	8GB (3.88GB Occupied by O/S, 4.12GB Available)
		Multimedia	Video Decoder - MPEG1/2/4, H.263, H.264/AVC - UHD H.264/AVC, VC-1, AVS/AVS+, MVC - VP8, VP9, HEVC, JPEG Audio DSP(Decoder) - MPEG, AC3, AC4, DD, MP3 and etc	Video Decoder - MPEG1/2/4, H.263, H.264/AVC - UHD H.264/AVC, VC-1, AVS/AVS+, MVC - VP8, VP9, HEVC, JPEG Audio DSP(Decoder) - MPEG, AC3, AC4, DD, MP3 and etc
		IO Ports	USB 2.0	USB 2.0
		Operating System	Tizen 3.0 (VDLinux)	Tizen 3.0 (VDLinux)
Accessories	Included		Passive Pen, Power Cable	Passive Pen, Power Cable
		Stand	Optional	Optional
	Optional	Mount	Optional	Optional
		Specialty	New MagicIWB S5 UX	New MagicIWB S5 UX

## About Samsung Electronics Co., Ltd.

Samsung inspires the world and shapes the future with transformative ideas and technologies. The company is redefining the worlds of TVs, smartphones, wearable devices, tablets, digital appliances, network systems, and memory, system LSI, foundry and LED solutions. For the latest news, please visit the Samsung Newsroom at <http://news.samsung.com>.

## SMART Signage

For more information about Samsung SMART Signage QBH-TR / QBN-W Series Displays, visit [www.samsung.com/business](http://www.samsung.com/business) or [www.samsung.com/displaysolutions](http://www.samsung.com/displaysolutions)

Copyright © 2019 Samsung Electronics Co. Ltd. All rights reserved. Samsung is a registered trademark of Samsung Electronics Co. Ltd. Specifications and designs are subject to change without notice. Non-metric weights and measurements are approximate. All data were deemed correct at time of creation. Samsung is not liable for errors or omissions. All brand, product, service names and logos are trademarks and/or registered trademarks of their respective owners and are hereby recognized and acknowledged.

Samsung Electronics Co., Ltd.  
416, Maetan 3-dong, Yeongtong-gu, Suwon-si, Gyeonggi-do 443-772, Korea

2019-01

**SAMSUNG**